

CE-MX444T70

**4K@60Hz HDMI 4Port Matrix
Switcher + Extender**



Lightning Protection
Surge Protection
ESD Protection



**Multi Audio
Formating**



Zero Latency

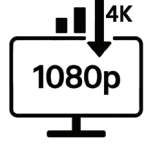

**Auto Down
Scaling**



PoC



4 Way Control

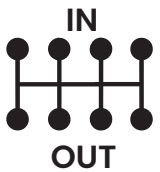

**4 HDMI Inputs
4 HDMI Outputs**

4K

4k@60Hz

**VIVID
STREAM**

VIVID STREAM



24/7

Connection Diagram

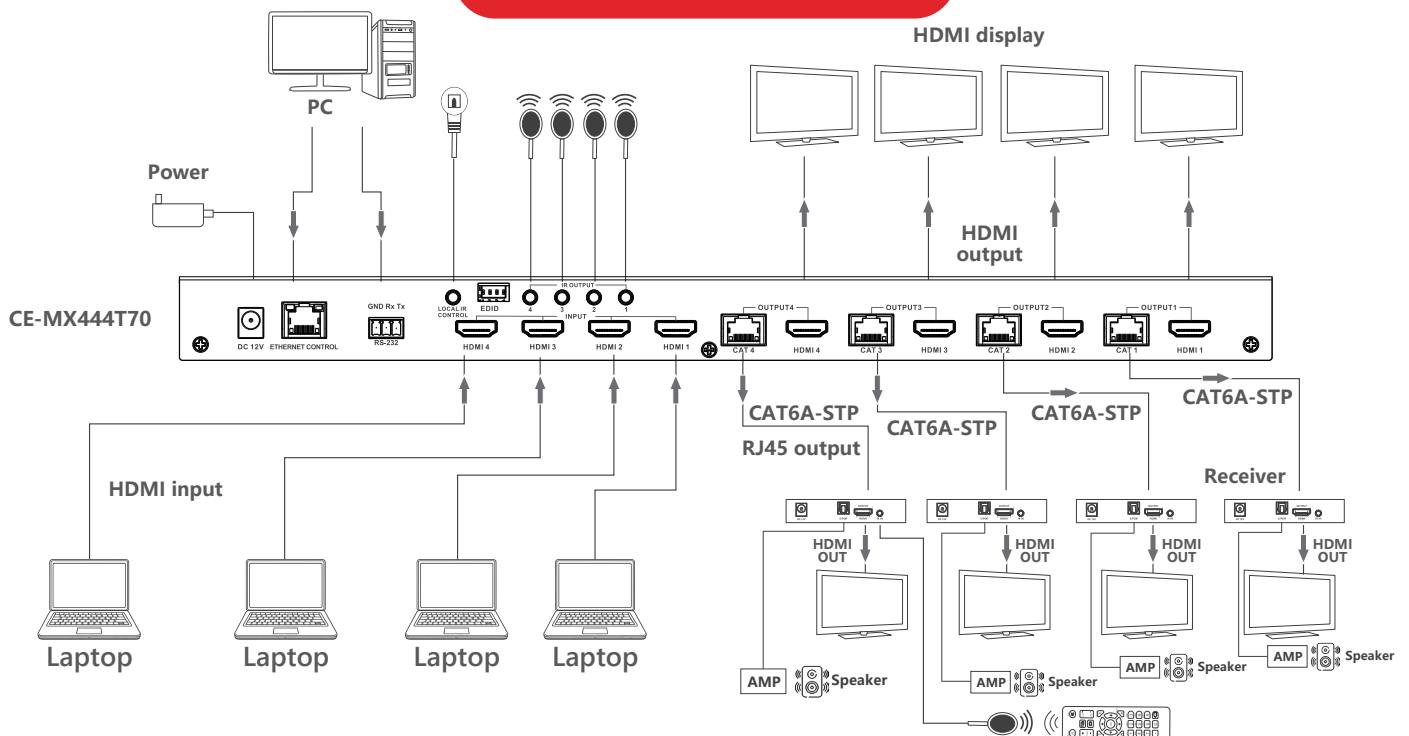

Features

Precision in Every Frame – Stunning 4K @ 60Hz Performance

Perfectly suited for high-speed visuals, real-time content, and professional-grade AV — all with zero lag, zero compromise.

Experience the brilliance of full 4K at 60Hz, delivering ultra-smooth motion, rich color depth, and crisp detail — even over long distances with UNIQ HDMI 4K60Hz extenders



VIVID STREAM — Experience Visuals Like Never Before

Step into a new era of stunning clarity. VividStream, powered by advanced IPColour iStream technology, delivers breathtaking visual performance—making every frame remarkably vivid and lifelike

What You'll See and Feel

- ▶ **Brilliant Colour Brightness**
Sharper tones with greater visual punch
- ▶ **True Gradation**
Maintains natural transitions and original depth
- ▶ **Optimised Contrast**
Enhances detail and dimension in every scene
- ▶ **Crystal-Clear Quality**
Zero noise, zero distortion
- ▶ **Real-Time Streaming**
Ultra-smooth performance with no delay

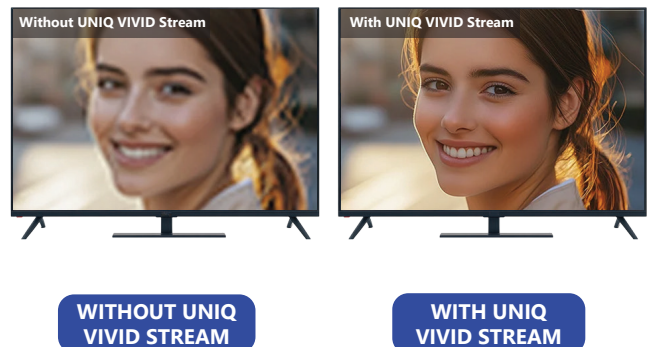

Independent Switching for Every Display

- ▶ Delivers 4K60Hz HDR content via CAT6/6A cable up to 70 meters
- ▶ Maintains stable signal across large rooms or control spaces
- ▶ Optimized for high-definition broadcasting, video walls, and demos

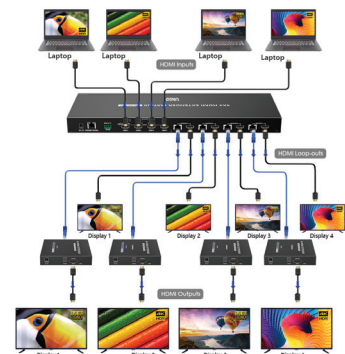

Mix 4K & 1080p Displays Without Hassle with Auto Downscaling Technology

- ▶ Detects each display's resolution and auto-adjusts output.
- ▶ Outputs 4K or 1080p depending on connected monitor
- ▶ Ensures compatibility with older displays

Product Specifications CE-MX444T70

Item	Transmitter		Receiver
HDMI version	HDMI 2.0		
HDCP Version	HDCP2.2, HDCP1.4		
Transmission media	Cat6/Cat6A/Cat7		
Transmission distance	≤70m		
Video bandwidth	600MHz (18Gbps)		
Resolution supported	3840×2160@24/25/30/50/60Hz, 4096×2160@24/25Hz, 1080i@50/60Hz, 1080p@50/60Hz, 720p@50/60Hz, 576i@50Hz, 576p@50Hz, 480i@60Hz, 480p@60Hz, 3440×1440, 2560×1440, 2560×1080, 2048×1080, 1920×1440, 1280×960, 1280×800, 1280×768, 1680×1050, 1360×768, 1366×768, 1600×900, 1024×768, 800×600		
HDR10	√		
HDMI Loop Out	√		-
IR Passback	Unidirectional		
S/PDIF audio separation	-		-
EDID Dip Switch	√		-
Audio format supported	LPCM/DTS-HD/DTS-Audio/Dolby Digital 5.1CH/Dolby Atmos		
Input TMDS Signal	0.5~1.2Vp-p		
Input DDC Signal	5Vp-p		
RS-232 Control	√		
Ethernet Control	√		
Remote Control	√		
Power over cable (PoC)	TX to RX		
I/O interface	HDMI IN x4, HDMI Loop Out x4 3.5mm jack x4(IR)		HDMI OUT x1
	RJ45 OUT x4, RJ45 x1(Ethernet)		RJ45 IN x1
	3-Pin RS-232, EDID DIP switch		3.5mm jack x1(IR) S/PDIF OUT x1
HDMI Interface	Type A 19 Pins, Female		
Case material	Iron		
Dimensions	411.0(L) × 147.0(W) × 29.0(H) mm		105.5(L) x 102.5(W) x 20(H) mm
Weight	1530g		243g
Color	Black		
Power supply	DC12V/3A		
Consumption	TX+RX≤30W		
Working temperature	-20~60 °C		
Storage temperature	-30~70 °C		
Humidity (no condensation)	0~90%RH (no condensation)		
Protection	ESD protection, 1a Contact discharge level 2 (±4KV) 1b Air discharge level 3 (±8KV) Implementation of the standard: IEC61000-4-2 Lightning protection, Surge protection		
Package Contents	1) Transmitter x1 2) Receiver x4 3) Power Adaptor DC12V/3A x1 4) IR Receiver extension Cable (local control) x1 5) IR Blaster extension Cable x4 6) IR Receiver extension Cable x4		7) Remote Control x1 8) Grounding Screw x5 9) Screw x24 10) Wall-mount Ears(TX) x2 11) Wall-mount Ears(RX) x8 12) RS-232 Terminal Block 3Pin x1 13) User Manual x1

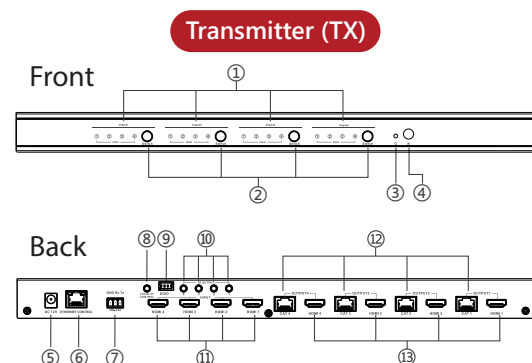

01	HDMI input indicators (1-4)
02	Switch
03	Power indicator
04	IR receiving window
05	DC12V power input
06	Ethernet control
07	RS-232 serial port
08	IR input (local)
09	EDID DIP switch
10	IR outputs (1-4)
11	HDMI inputs (1-4)
12	RJ45 outputs (1-4)
13	HDMI local outputs (1-4)

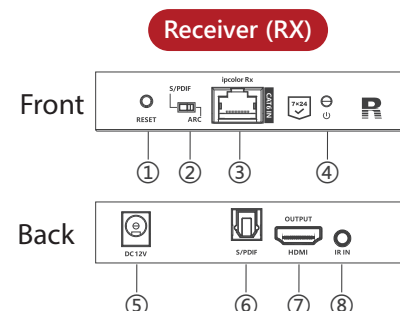

01	Reset button
02	Audio switch
03	RJ45 input
04	Power/Signal indicator
05	Spare power port
06	Digital audio signal output
07	HDMI output
08	IR input

Applications



Auditorium



NOC / SOC / CCC

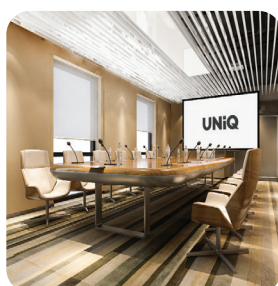

Conference-Room



Town Hall



Training Hall

Prestigious Lineup of Cutting-Edge Professional AV Products

Ai Interactive Displays

AiO | Pro | Education Series
65" | 75" | 86" | 98" | 100"



Active LED Video Wall

Indoor & Outdoor LED Walls
CoB, GOB, and
Custom Pixel Pitch Options



Video Conferencing Products & Professional Cameras

From AI Video Bars to PTZ Cameras
AiO Video Bars | AiO PTZ Video Bars
PTZ Cameras | Speakers Phone
Conferencing | Microphones | DSP



AV Interface Products

Extenders – CAT6 Wireless | Point-Point
KVM Extenders | Over-IP
Matrix & Splitter Cum Extenders
Splitters Switchers | Matrix



Disclaimer

- Specifications, features, visuals, and models are subject to change without notice.
- Product availability and features may vary by region.
- Colours/images shown are for reference only; actual product may differ.
- Warranty terms vary by model and region—refer to official documentation.
- We recommend staying updated via our official channels for the latest info.
- Performance may improve with software/firmware updates.
- All trademarks belong to their respective owners.
- We are not liable for typographical or illustrative errors.
- Please dispose of products responsibly as per local e-waste norms.
- Data (if applicable) is handled per our privacy and regulatory compliance.
- No liability is assumed for indirect or consequential damages